



Red Bridge Homes Association October 2017

It's been a while!

The board of the Red Bridge Homes Association is excited to publish, mail, email, and post this newsletter. It's been a while. Thanks for your patience.

As communications manager on the board, I hope to produce a newsletter that instills pride in our neighborhood and the surrounding community.

I am certain that there are many like me that are new to the area, and still trying to understand the ins and outs of the neighborhood. So, this newsletter will cover some of the basics.

- What area does the Red Bridge Homes Association cover?
- What does the homes association do?
- Who is on the board?
- What are the by-laws of the association?

Send newsletter feedback and ideas to eric.strautman@gmail.com

History of the Old Red Bridge

(Courtesy kcparks.org) The first red bridge was built by Colonel George N. Todd, a 50-year old Scottish stonemason. The 100-foot span, covered wooden bridge, on stone piers, was located just downstream from today's bridges at the actual trail

crossing. It was painted red, hence the origin of "Red Bridge."

The original bridge was torn down in 1892 and a steel bridge, called a "tin" bridge, also painted red replaced it. The 1859 bridge was dismantled and the wood recycled into barns by local farmers.

A third and current Old Red Bridge replaced the 1892 "tin" bridge and was dedicated by Harry S. Truman (when he was a judge) in 1932 during the Great Depression. The bridge, located on Red Bridge Road, between Holmes and Blue River Road, is made of concrete, steel and red granite. It was built by Jackson County; Richard Wakefield was the architect.

Red Bridge Homes Association Board Members

Ray Bucklew – President
816-942-2745 / r_bucklew@yahoo.com
Erin Wisemore – Treasurer
Cheri Kelly – Islands & Markers
Ellyn Connor
Patrick Parker – Snow Removal
Steve Wagge
Von Fett
Eric Strautman – Newsletter
Sharon Hill – Community Liaison & Sidewalks

By-Laws:
<http://ha-kc.org/data/bylaws/RBAamended%20Bylaws.pdf>

Red Bridge Shopping Center Renovation

The 2016, \$19 million renovation of Red Bridge Shopping Center has secured many new retail tenants, and there will be more to come! Here are just a handful: Blue Bicycle Fitness, Wonderscope Children's Museum, SERC physical and hand therapy, Blue Moose Bar & Grill, Silks and Poles Aerial Fitness, and Eustons Hardware.



Red Bridge Shopping Center's development was first announced in 1958.



Fall Leaf & Brush Pick-Up

10/25 and 11/29

Please support these local businesses and others in the area. Doing so will raise property values, and stimulate additional renovation and development. So, avoid the temptation to burn gas to go somewhere else and save a few bucks. Spending your money here makes the most sense.

Consider Joining Red Bridge Nextdoor

Nextdoor is an online resource for active neighborhoods. Like any other site where people contribute information, ideas, and opinions, you need to filter out the junk to get to the good stuff. But always remember that one man's junk is another's treasure! Just be civil.

<https://redbridgekc.nextdoor.com/>

No-Charge Bulky Item Pick Up

The City's no-charge, appointment-based Bulky Item Collection Program is for disposal of large household items that cannot be handled in the regular weekly trash collection.

- Make an appointment online using the [Online Bulky Scheduler](#).
- By phone: Call 311 or 816-513-1313 to schedule an appointment.
- Appointments must be made up to 48 hours prior to the service date.
- Collections will not be made without an appointment.
- Items must meet guidelines for large item collection

Spend Locally to Build Equity

Neighbors, please give our retail neighbors your business. It is really nice to have good retail so close, and elevating the value of our homes. But they will only stay if they prosper. You might save a few dollars driving across town or shopping on Amazon, but that will NOT add a dime of value to your property. It makes sense to spend locally if you take time to think it through.

This issue's highlighted retailer: **Euston Neighborhood Hardware**

Euston Neighborhood Hardware is the extension of a real-life, good old fashioned hardware store operating in the Kansas City area since 1971.

Originally founded by Ken Euston, the stores are currently run by one of his sons, Kevin. The family owns three locations other than Euston Hardware at Red Bridge including Euston Hardware in Prairie Village, Kansas, Waldo Hardware in Kansas City, Missouri, and Pack's Hardware in Smithville, Missouri.



REMINDER: Keep storm water drains clear! In 2016 we experienced several deluges of rain that overwhelmed our storm water system. Do your part to keep drains and creeks clear of trash and vegetation

What does the Red Bridge Homes Association Do?

The RBHA collects \$75 annually from about 850 homeowners in the defined area the association services (see map on page 3). This money is used to beautify the area's markers and islands with maintained flower beds and other plantings. The board also approves expenditures for painting, tuck-pointing, sandblasting and other upkeep of the signage that delineates our neighborhood. The board also contracts annually for snow plowing and ice treatments, as a faster and more thorough supplement to city services.

The board also promotes the annual RBHA garage sale, putting up banners throughout the area and publicizing it through various communication channels. The garage sale is held the first weekend

of June each year. Any home in the RBHA is welcome to participate.

Update on Islands and Markers

Islands and markers give the first impression of a neighborhood to visitors and potential residents. They also serve as a source of pride for current residents as they beautify the area and provide a welcoming symbol to others. Unfortunately, many of our islands and markers have suffered from neglect, and no longer exude the message we want to convey.

This was discussed at the annual meeting in 2016. The board hired a company in 2017, but their performance was lacking.

We have recently contracted with a new company that will work with us to change out the markers and create a more lasting and beautiful statement.

As with any project it takes time to get things right. We expect to start small and phase in plant material over the next few years to accomplish our goal of providing a great first impression.

As it is approaching the winter months, you may notice only small improvements at first. However, come Spring, you should see more going on. And, in the next few years, things will pick up even more as our project progresses. In order to keep in line with funding, a "phase-in" approach will be used for not only markers but the islands as well. Although we should be able to make changes in the first year to all markers, the islands need to be handled differently. We will attempt to prioritize their need for any changes and focus first on those needing the most. We thank all our residents in advance for their patience and welcome any feedback. Look forward in the next few months to more color and plant material that really shouts

"Red Bridge – a great place to live!"

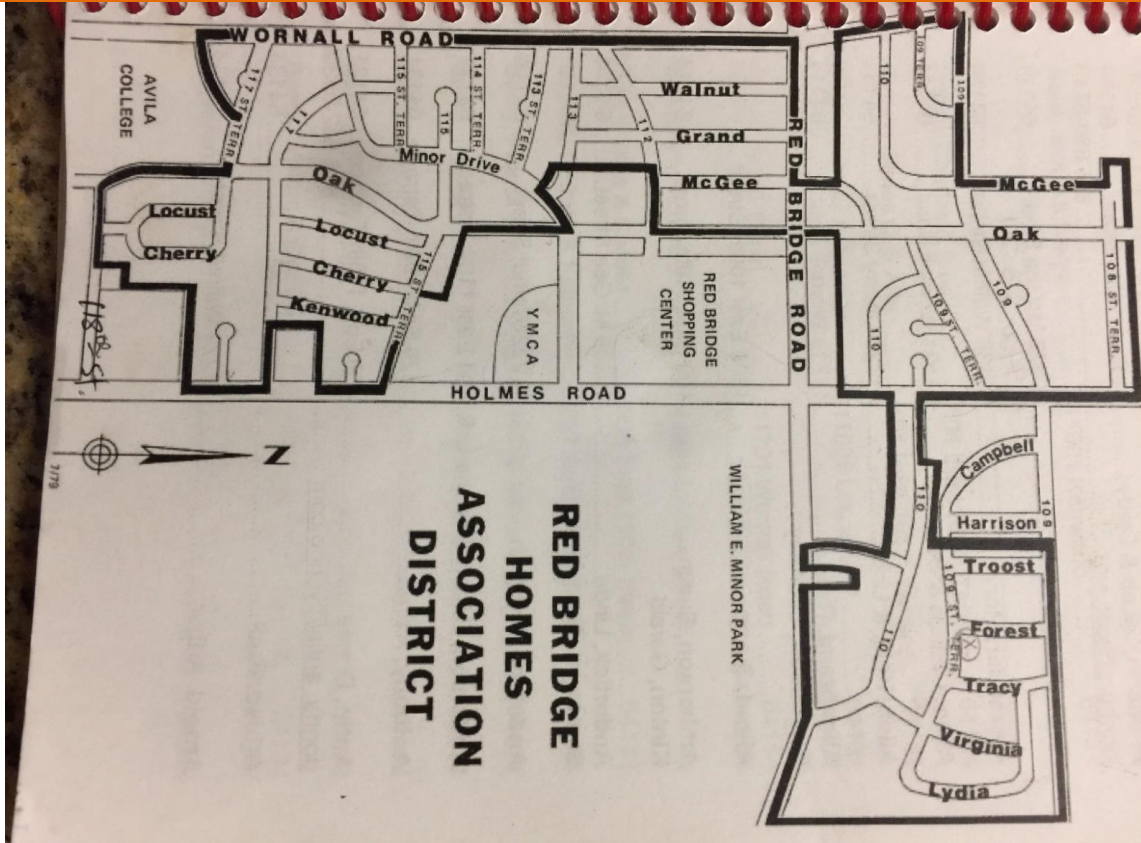

Red Bridge Homes Association

4200 Somerset Dr., Ste. 216
Prairie Village, KS 66208

RETURN SERVICE REQUESTED

**NOTICE OF RBHOA
2017 ANNUAL MEETING**

Saturday, November 4th
10:00 AM

St. Mark's
Coptic Christian Church
700 E. 110th Street
KCMO 64131